



EDWARD ANDREWS INTERNATIONAL

"Tooling and Workholding Specialist in the Metal Cutting Industry"

STERLING HEIGHTS, MICHIGAN

CAT 40

ER COLLET CHUCKS - CAT40

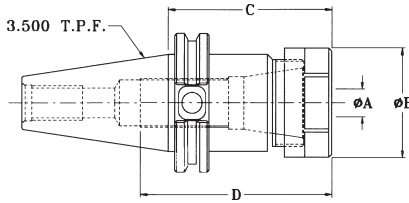

EA PART NUMBER	COLLET SERIES	A COLLET RANGE	B DIA.	C	D	COMP NUT	STOP SCREW	COLLET NUT WRENCH
EAV40ER-11-300	ER11	.019-.276	.63	3.00	4.00	EAERCN-11M	5/16-LH	ER11MW
EAV40ER-16-250	ER16	.019-.393	1.10	2.50	3.00	EAERCN-16	7/16-LH	ER16HW
EAV40ER-16-500	ER16	.019-.393	1.10	5.00	3.00	EAERCN-16	7/16-LH	ER16HW
EAV40ER-20-275	ER20	.039-.512	1.34	2.75	3.00	EAERCN-20	9/16-LH	ER20HW
EAV40ER-20-400	ER20	.039-.512	1.34	4.00	3.00	EAERCN-20	9/16-LH	ER20HW
EAV40ER-20-525	ER20	.039-.512	1.34	5.25	3.00	EAERCN-20	9/16-LH	ER20HW
EAV40ER-25-250	ER25	.039-.630	1.65	2.50	3.00	EAERCN-25	M18LH	ER25SW
EAV40ER-25-400	ER25	.039-.630	1.65	4.00	3.00	EAERCN-25	M18LH	ER25SW
EAV40ER-25-600	ER25	.039-.630	1.65	6.00	3.00	EAERCN-25	M18LH	ER25SW
EAV40ER-32-238	ER32	.078-.787	1.97	2.38	3.00	EAERCN-32	7/8-LH	ER32SW
EAV40ER-32-300	ER32	.078-.787	1.97	3.00	3.00	EAERCN-32	7/8-LH	ER32SW
EAV40ER-32-400	ER32	.078-.787	1.97	4.00	3.00	EAERCN-32	7/8-LH	ER32SW
EAV40ER-32-600	ER32	.078-.787	1.97	6.00	3.00	EAERCN-32	7/8-LH	ER32SW
EAV40ER-40-315	ER40	.394-1.339	3.07	3.15	5.00	EAERCN-40	1-1/8-LH	ER40SW

Order retention knobs separately, specify machine make and model#.

Includes collet nut and standard stop screw. Purchase collets and wrenches separately.

Note! Collet must be assembled into collet nut before inserting tool and assembling onto chuck.

Note! Do not exceed the following torque recommendations: ER11 - 25ft/lbs ER16 - 40ft/lbs ER20 - 65ft/lbs ER25 - 65ft/lbs ER32 - 80ft/lbs ER40 - 90ft/lbs.

CAT40 MORSE TAPER ADAPTERS

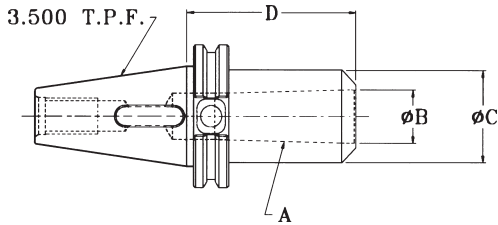

EA PART NUMBER	A MORSE TAPER	B DIA.	C DIA.	D
EAV40-MT1	1	.475	1.00	1.75
EAV40-MT2	2	.700	1.25	2.44
EAV40-MT3	3	.938	1.62	3.00
EAV40-MT4	4	1.231	2.00	3.75

Order retention knob separately, specify machine make and model#.

CAT40 JACOBS TAPER ADAPTERS

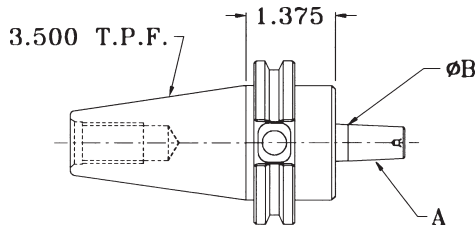

EA PART NUMBER	A JACOBS TAPER	B DIA.
EAV40-JT2	2	.559
EAV40-JT3	3	.811
EAV40-JT4	4	1.12
EAV40-JT6	6	.676
EAV40-JT33	33	.624

Order retention knob separately, specify machine make and model#.